

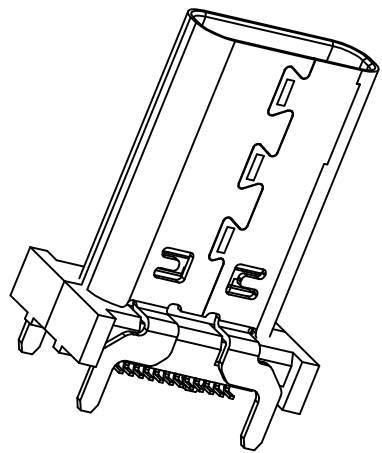

◇	为了高频优化, 更改中夹片形状			MJO	2024. 03. 22
LTR	ECN NO	REVISION	RECORD	DRAW	DATE

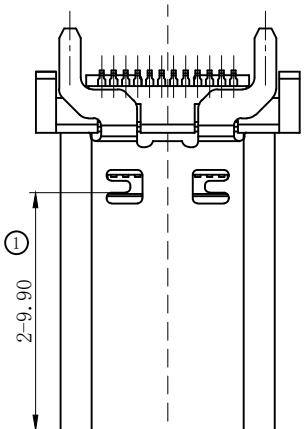

料号备注:
C-TF428-PH47XXY-1A

- *01"镀金1U"
- *02"镀金3U"
- *03"镀金5U"
- *04"镀金15U"
- *05"镀金30U"
- *06"半镀1U"
- *08"半镀15U"
- *10"半镀30U"

NOTE:

1.MATERIAL:

- 1.1 INSULATOR: PA9T UL94V-0 COLOR:BLACK;
- 1.2 CONTACT: C7025 T=0.12mm
- 1.3 SHELL:SUS304 T=0.3mm

2.PLATING

- 2.1 TERMINAL CONTACT: GOLD 1U" PLATED ON CONTACT AREA 30U" Min NICKEL UNDER-PLATED
- 2.2 SHELL:30U" Min. NICKEL ALL OVER

3.ELECTRICAL CHARACTERISTICS;

- 3.1 CONTACT RESISTANCE: 40mΩ Max FOR INITIAL. 10mΩ CHANGE AFTER TEST. MEASURE AT 20mV, 100mA.
- 3.2 CONTACT CURRENT RATING: 5A FOR VBUS PIN; 1.25A FOR VCONN PIN,0.25A FOR OTHER PIN
- 3.3 DIELECTRIC WITHSTANDING VOLTAGE: 100V AC R.M.S.
- 3.4 INSULATION RESISTANCE 100MΩ Min
- 3.5 OPERATING TEMPERATURE: -25°C ~ 85°C

4. MECHANICAL CHARACTERISTICS:

- 4.1 MATING FORCE: 5~20 N.
- 4.2 UNMATED FORCE: 8~20N AFTER TEST
- 4.3 DURABILITY: 10,000 CYCLES
- 5.SALT SPRAY: GOLD&NICKEL AREA 48H

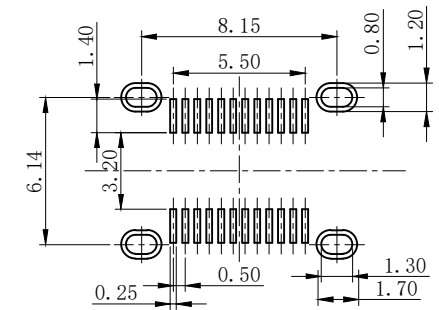
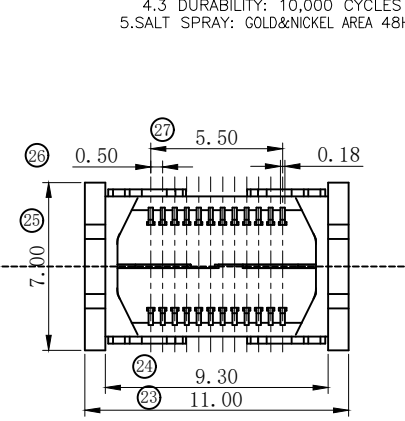
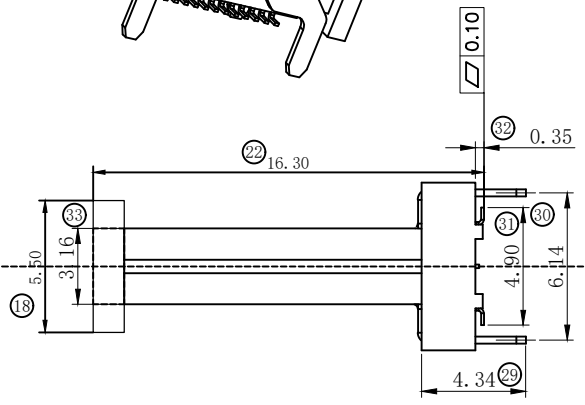
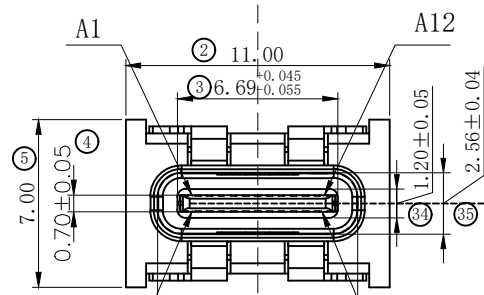

RECOMMENDED PCB LAYOUT (TOP VIEW)
DEFAULT TOLERANCE: ±0.05

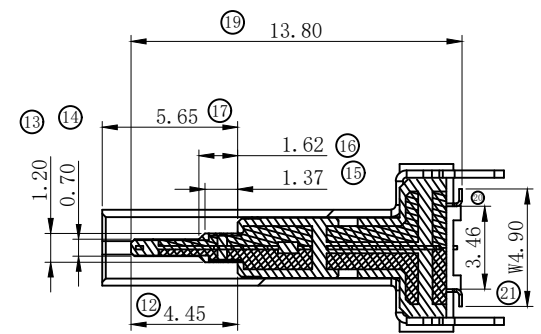
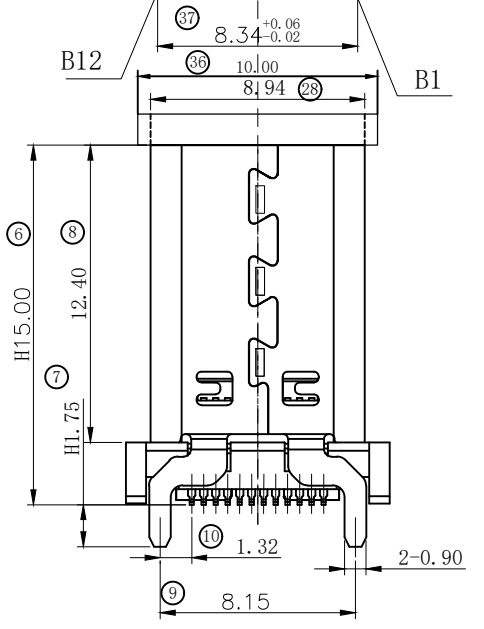

TOLERANCE:		UNIT		深圳市同心富精密电子有限公司 Shenzhen TXF Precision Electronics Co., LTD			
X. ±0.50	X.° ±1°	MM					
.X ±0.35	.X° ±1°	SHEET		DRAW:	Andy	2023. 3. 27	P/N: C-TF428-PH47XXY-1A
.XX ±0.25	.XX° ±1.0°	1/3		DESIGN:	Andy	2023. 3. 27	ITEM: USB 3.1 CF 母座24PIN黑色PA9T, 直立式SMT H=15mm, 脚长H1.75MM 端子(C7025)镀金10", 外壳镀镍, 带防尘盖, 卷装四脚无弹片
.XXX ±0.10	.XXX° ±1.0°	SCALE		CHECK:	Mijo	2023. 3. 27	
		REV: A1		APPR:			DRW NO: C001